

AI LENS, MICROBIT, CUTEBOT Y MAKECODE

Para poder usar AI LENS con MAKECODE y MICROBIT entramos en un proyecto y en EXTENSIONES

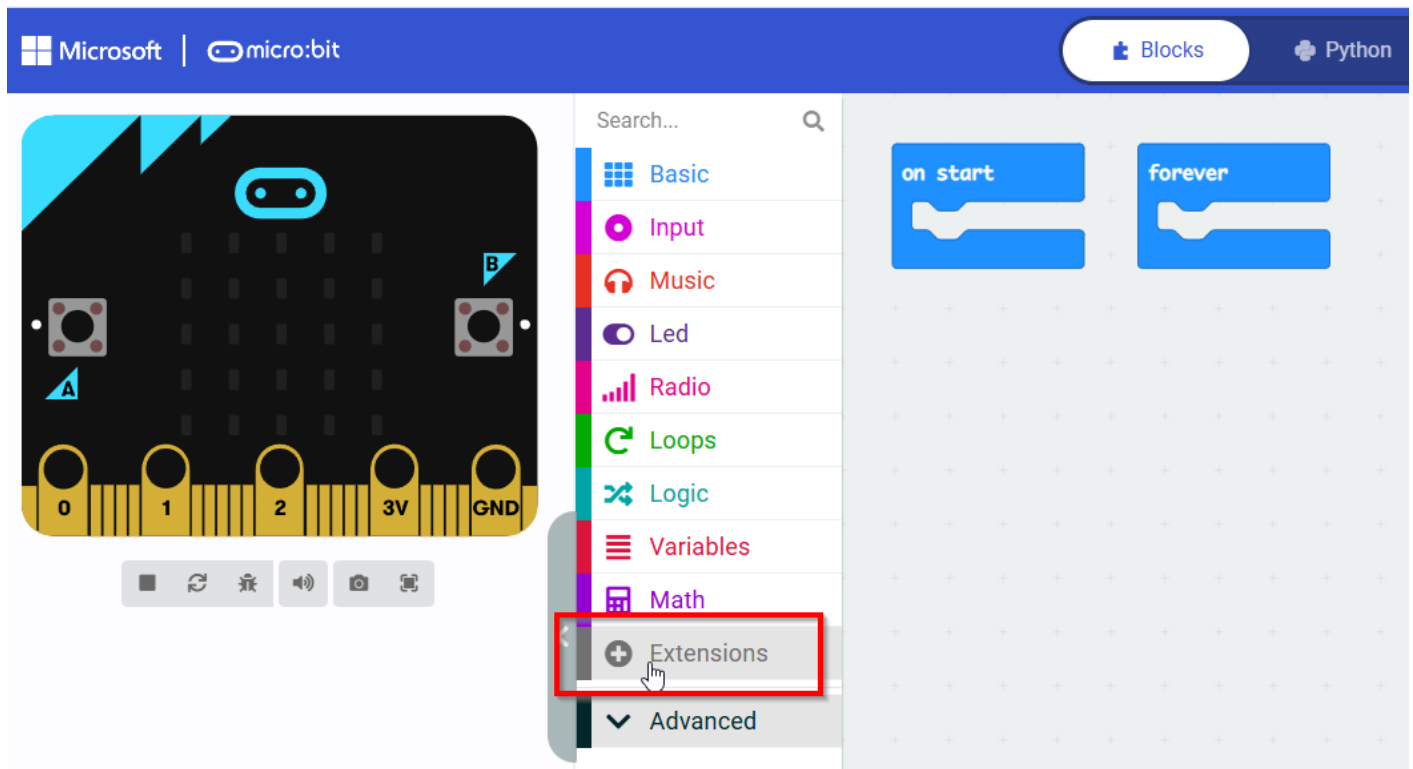

Elegimos la extensión CUTEBOT para poder usar este robot

CUTEBOT

Lights and Display

Software

Science



cutebot
(酷比特) micro:bit smart cutebot by
ELEC Freaks

[Learn More](#)

Cutebot-Pro
(酷霸/酷比特Pro)n
cutebot pro by ELE

y VOLVEMOS A EXTENSIONES E INSTALAMOS LA DE AI LENS

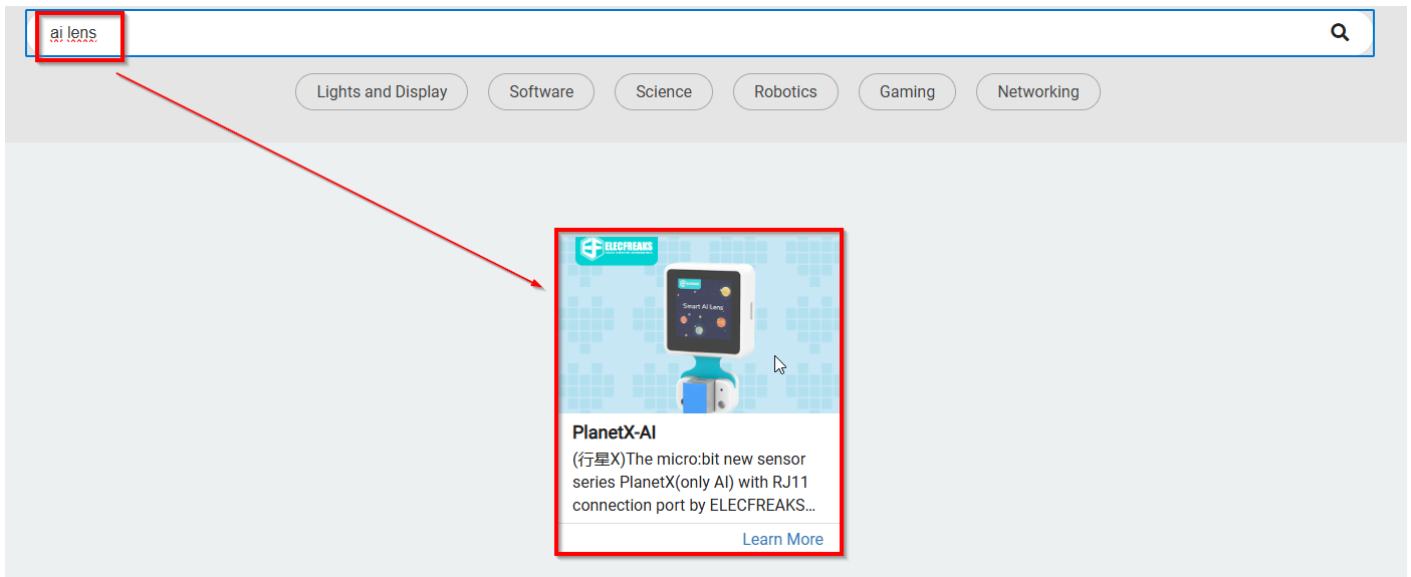

Ya lo tenemos todo preparado :

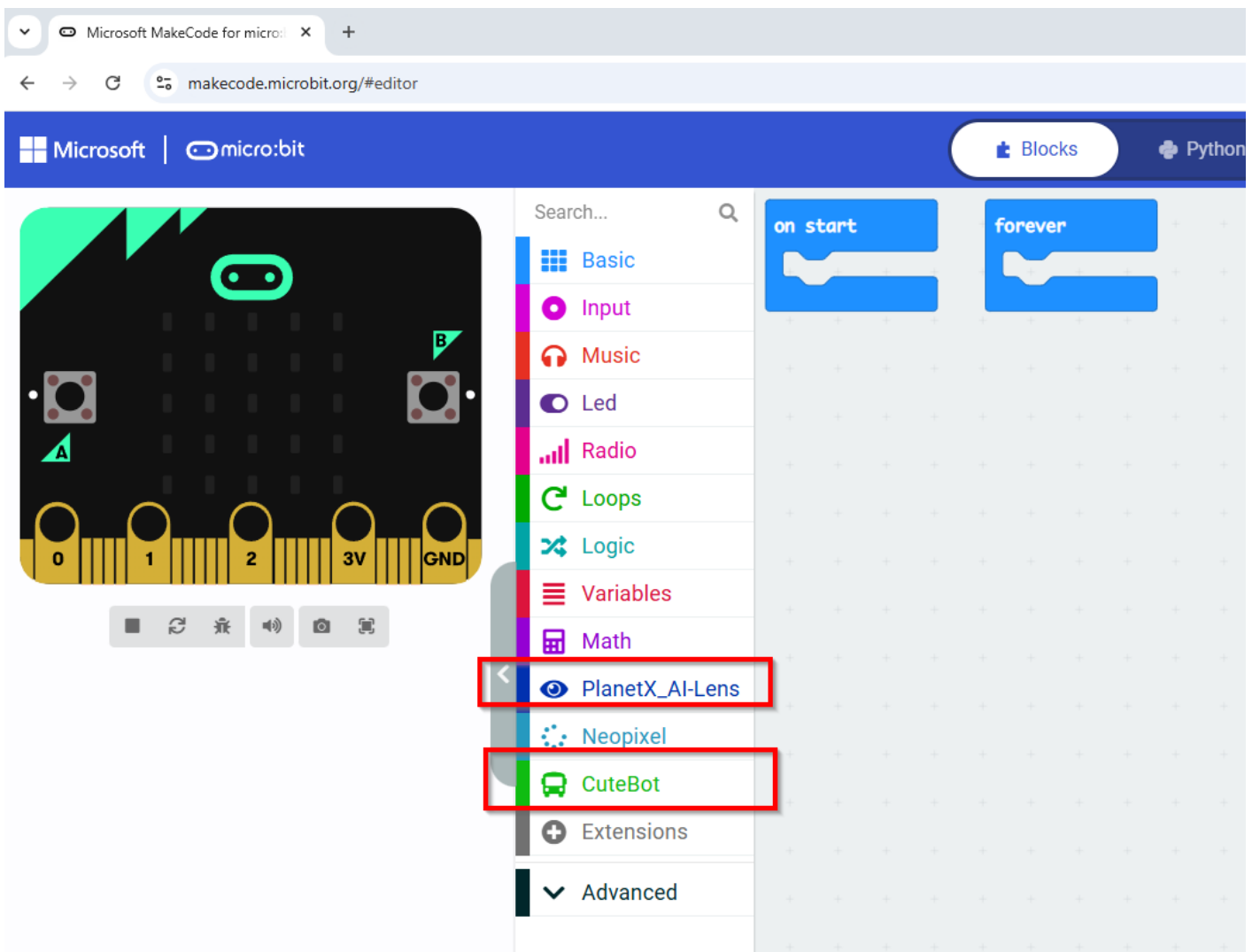

Revision #1

Created 5 November 2024 14:40:20 by Javier Quintana

Updated 5 November 2024 14:45:21 by Javier Quintana